

# **Exhibition Information Pack**

**Introduction**

**Exhibition Essentials**

**Selection Process & Exhibiting**

Campbelltown ArtHouse Inc.

Brookside Cellars Community Arts Centre, 17 Moore Street, Tranmere SA 5073

## Introduction

### ABOUT THE CAMPBELLTOWN ARTHOUSE

The Campbelltown ArtHouse is an independent and not-for-profit, visual arts gallery and workshop space, managed entirely by volunteers. It promotes arts activity by providing an inclusive environment that supports innovation and facilitates, educates and encourages artists of all levels to come together, share their talents and display their artwork in the gallery.

The Brookside Cellars Community Arts Centre Gallery is an 1870's stone building situated at 17 Moore Street Tranmere, adjacent Third Creek. There is one large rectangular room in which to display artworks.

The Campbelltown ArtHouse encourages diversity, experimentation and artworks that offer the public the opportunity to be delighted as well as challenged.

Members stage at least two exhibitions a year – SALA (August) and the Fringe (February/March), and often an additional exhibition in December.

Applications to exhibit at the Gallery are welcome from established and emerging artists in other months as part of the ArtHouse's annual program. Please note that applications are subject to a selection process.

### FLOOR PLAN

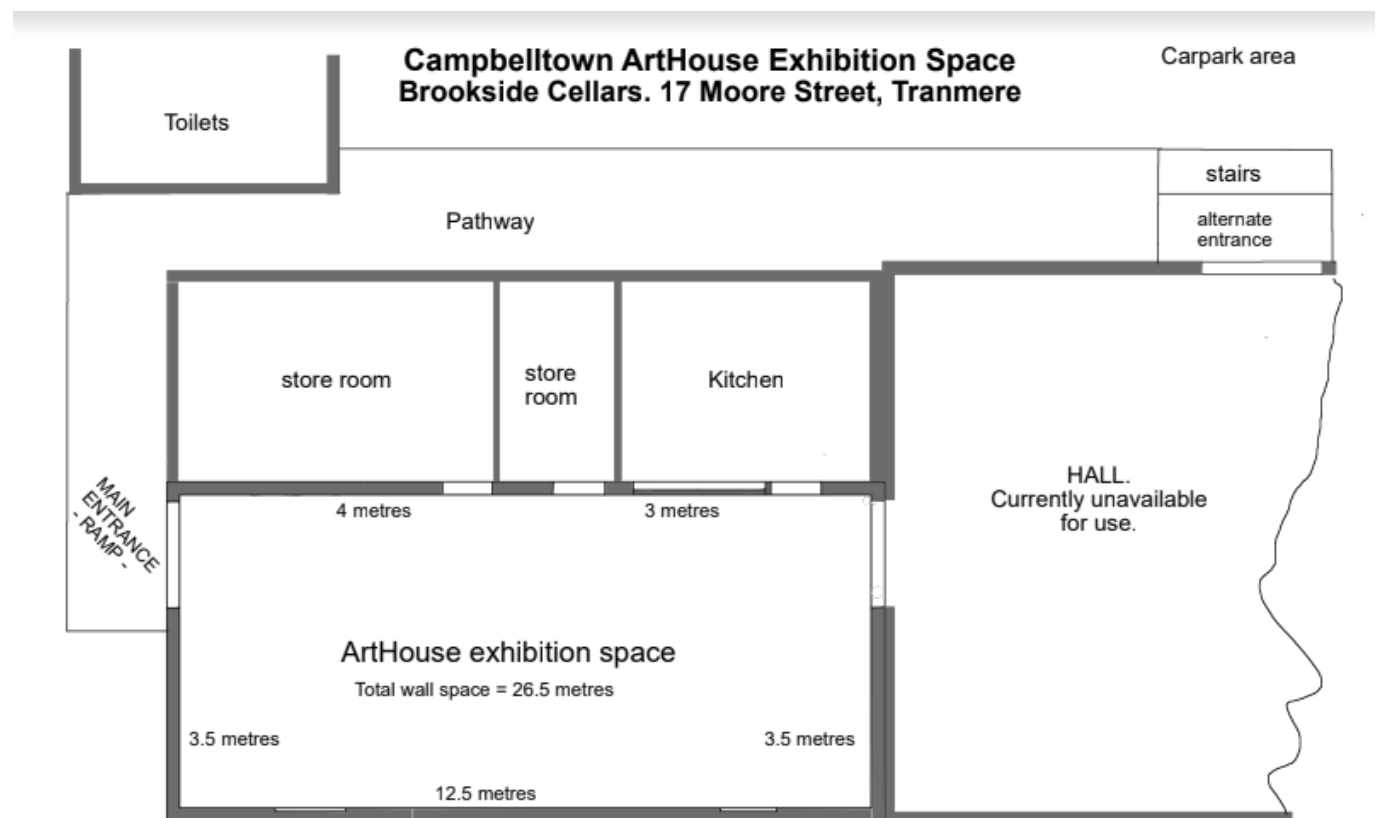

### OPENING HOURS AND GALLERY WEEKLY USE

The Gallery is to open on Thursdays between 10:00am and 3:00pm and between 12:00 and 4:00 pm on Saturdays and Sundays. It is staffed by volunteers.

Public programs, including classes and talks are held in the gallery alongside exhibitions.

## Exhibition Information

### EXHIBITION OPTIONS AND COSTS

Exhibitions are normally three to four weeks in length, depending on the time of year.

Description	Fee
Exhibition fee	\$150
Commission on sale of exhibition pieces	20% Commission

### EXHIBITION INCLUSIONS

- Exhibition period of 3-4 weeks (adjusted during the Christmas/New Year period or other times of the year)
- Minimum exhibition duration is 2 weeks.
- Promotion via the Campbelltown ArtHouse website, social media and newsletters.

### ARTWORK SALES

A minimum of 80% of items within the Exhibition must be for sale.

If an Artwork has sold, up to 30 days after the Campbelltown ArtHouse has been paid for the work in full, the artist will receive the price paid by the buyer for the sold work less the commission of 20% of the retail price of the work.

### EXHIBITOR RESPONSIBILITIES

The responsibilities are outlined in the Exhibition Agreement.

### WELL-BEING

Whether you are an experienced exhibitor or installing your first exhibition, it's an exciting period, requiring a lot of work and energy. It's important to ensure you take care of both your physical and emotional wellbeing before and after the exhibition.

The lead up to an exhibition may produce a myriad of emotions and when an exhibition is over, it is not unusual for artists to feel physically and mentally drained; wondering what is next, what do I do now?

It is important to talk with family and friends, and with other artists. Professional support can also be provided by the following services".

**Beyond Blue** 1300 22 4636

**Life Line** 13 11 14

or speak with your GP

## Selection Process

### EXHIBITOR SELECTION PROCESS

- Applications are considered on an ongoing basis
- Successful exhibitors will be notified by telephone, confirmed in writing and issued with an Exhibition Agreement to sign.

The **Arthouse Artist Advisory Group**, considers each application on its own merit and selection criteria is based upon

- Quality or artistic merit of the artwork (based on images supplied by applicant).
- Diversity of artforms, artist and exhibition concepts, to achieve a varied annual exhibition program.
- Suitability for the location
- Number of Artworks proposed for display
- Experience of the artist
- Proposed exhibition concept or theme

### APPLICATION PROCESS

The following must be included as attachments to your online application form:

- Resume for each artist exhibiting (1 page only)
- An exhibition concept document of your proposed exhibition (approx. 300 words)  
*If this is a group exhibition only one concept document is required, representing all the artists.*
- Artist Statements from each artist (approx. 50 words)
- Images of proposed work or similar.

Print Quality JPEG images (approximate size 1-4MB at 300dpi)

- Two images
- Artwork Image list must accompany the images (artist name, artwork title, year artwork produced)  
eg: TSmith\_Silence\_2017.jpg
- Images may be supplied on USB with your application if you are unable to upload them online

### APPLY ONLINE

If you are unable to submit your application online, please contact the Galley Manager for assistance.

Email: [gallery@arthouse.org.au](mailto:gallery@arthouse.org.au)